

View A

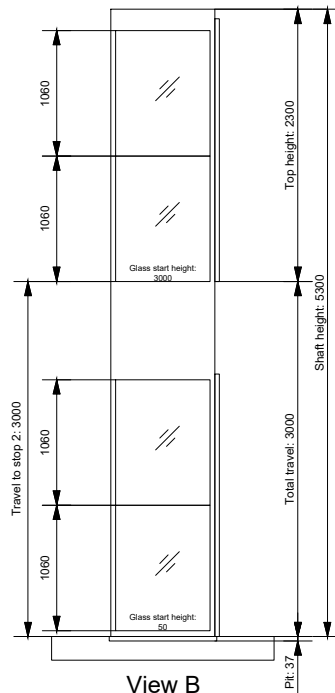

View B

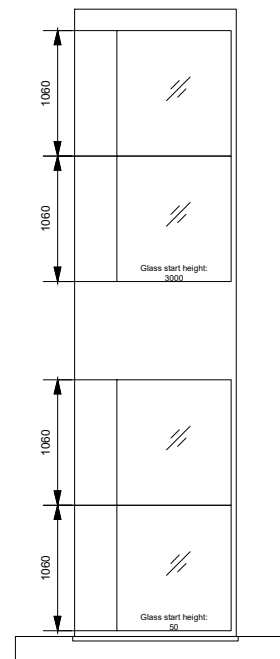

View C

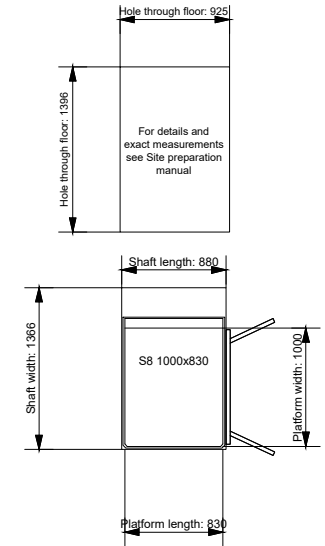

View C View A
View B

Aritco HomeLift S8 1000x830 Ratings Shaft Load: 250kg/3 pers. Speed: 0.15m/s DesignWall RAL9016 Door RAL9016 Backside FullyCased DesignLight White Right Driver 230V 1-phase Ceiling Ceiling - Stars Phone AutoDialerGSM Floor Glass Mast length 5014 mm Screw length 4296 mm Trailingcable length 5600 mm			
	View A	View B	View C
Stop 2			
View A			
Door Double door			
Glass			
Stop 1			
View A			
Door Double door			
Glass			
Aritco HomeLift Revision number: 01 Order number: AR343843 Site name: FOR QR CODE Ref. no.: Order date: November 7, 2025 Signature: _____			

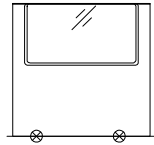

Note that all doors shall
be fixed to the floor

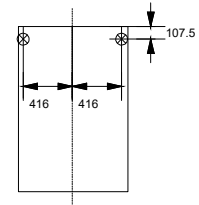

Incoming power: electrical cabinet
placed in mast bottom

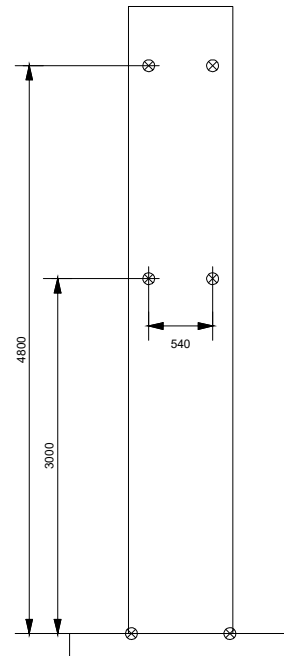
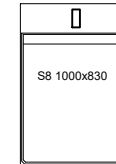

View D

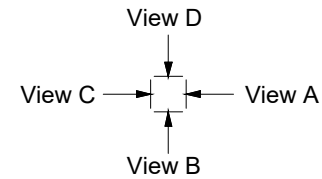

<div></div>		Aritco HomeLift	
		Revision number: 01	
Order number:		Site name: FOR QR CODE	
AR343843		Ref. no.:	
<div><div></div><div></div></div>		Order date:	Signature: _____
		November 7, 2025	